

Suite 105/110

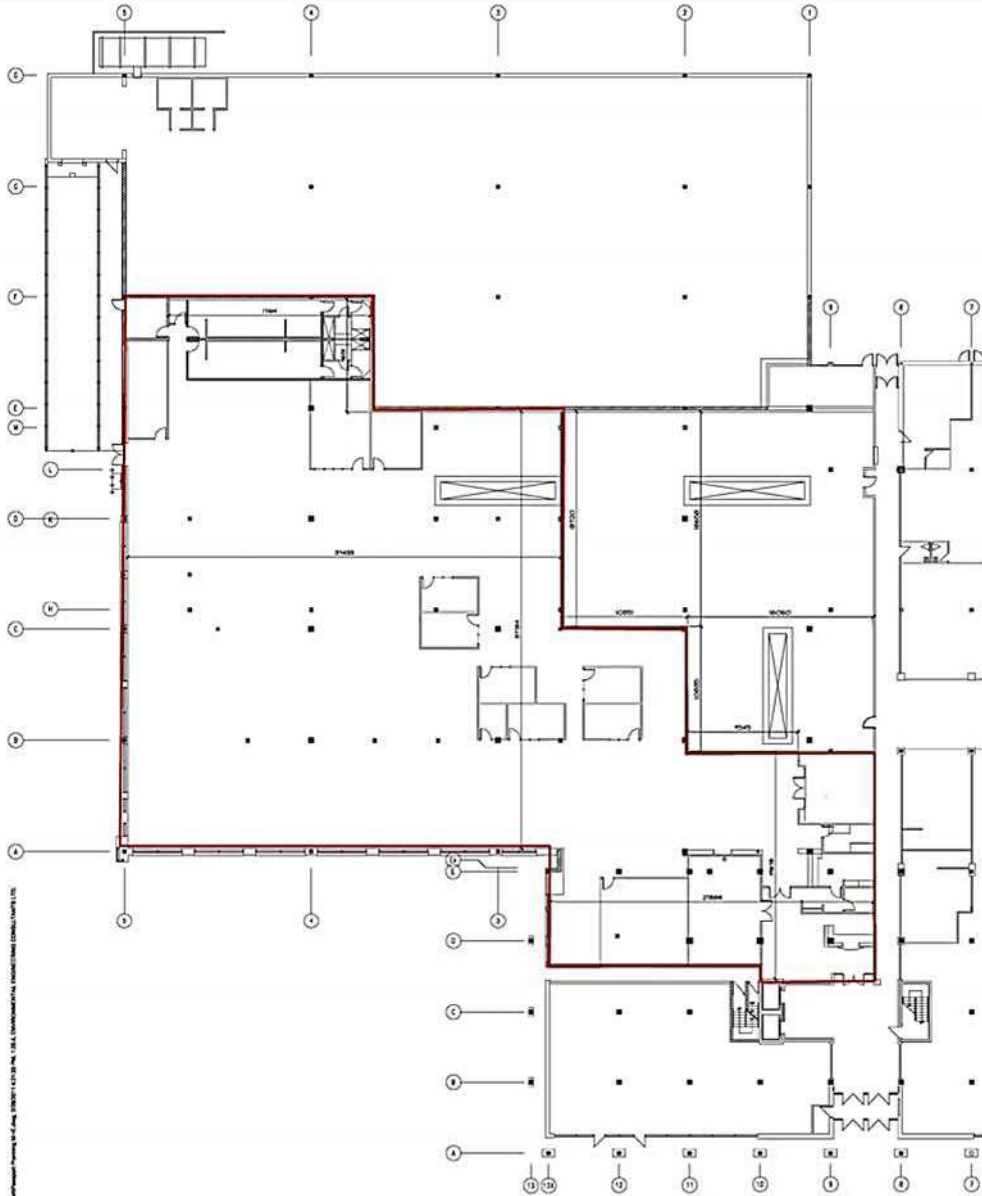

Project: Meadowlands Drive Ottawa, Ontario, Canada. Drawn by: VMD, Checked by: RIC, Date: DEC 10, 2009. OSGOOD PROPERTIES LTD.

NO.	REVISION	DATE

GROUND FLOOR
885 MEADOWLANDS DRIVE
OTTAWA, ON
OSGOODE PROPERTIES LTD.

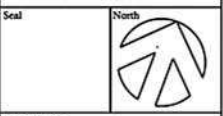

CONSTRUCTION PLAN AND DETAILS

Date	DEC 10	Drawing No.	A1
Scale	1 : 200		
Drawn by	VMD		
Designed by	RIC		
Project			